



All-in-One Washer-dryer

User Manual

Table of contents

Warnings	2
Getting to know your appliance	3
Installation	5
How to use	9
Troubleshooting	19
Cleaning and maintenance	21
Specifications	22

Warnings

Read this manual carefully before using the appliance and keep it properly for future reference. The company reserves the right to interpret the manual.

Safety instructions

This manual includes important information about the installation and use of the appliance. Please pay attention to the safety instructions and precautionary contents.

We are not responsible for failures and damages caused by non-compliance with installation instructions or improper use.

Before installation, check damages. Never attempt to install or operate the appliance if it is damaged, malfunctioning or has missing or broken parts.

1. The appliance must be grounded. In the event of breakdown, grounding will reduce the risk of electric shock.
2. Do not plug or unplug the power plug with wet hands, which may cause the risk of electric shock.
3. Do not install or store the appliance where it will be exposed to weather. Avoid water spillage. In case of flood, disconnect the power plug and contact customer service.
4. Unplug the appliance before cleaning or maintenance.
5. In “Hi Temp.” mode or drying mode, the machine body and air outlet will be hot. Please do not cover the machine body to prevent overheating. Please do not touch the machine body to prevent thermal burns.
6. Before use, please check the water tank and drain hose connections to prevent water leakage.
7. Keep the appliance away from heat sources, open flames or direct sunlight. Please install it in the place where temperature is above 0°C/32°F and with proper ventilation.
8. Do not wash or dry clothes contaminated with volatile substances.
9. Unauthorized repairs are not permitted.
10. Do not allow children to play with the appliance. Close supervision of children is necessary when the appliance is used near children.
11. Do not place flammable subjects such as cotton wool near the appliance.
12. If the power cord is damaged, for your safety, please unplug immediately. Power cord must be replaced by manufacturer or authorized personnel.
13. Do not put animals, such as pets into the appliance.

Getting to know your appliance

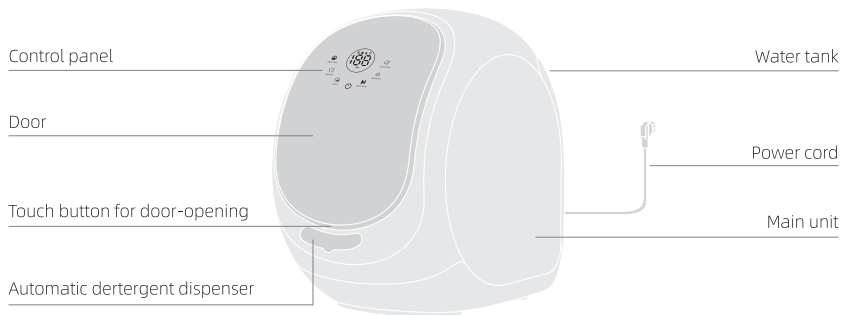

What's in the box



Hole cover cap x2

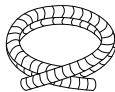

Drain hose x1



Drain hose clamp x1

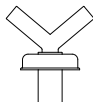

Y-piece drain hose connector x1



Laundry detergent cartridge x1



User manual x1

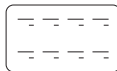

Quick start guide x1

Installation

Placement

The surface must be perfectly level and solid.

Maintain a min. distance of 10cm(4inch) between the appliance and each edge of the surface.

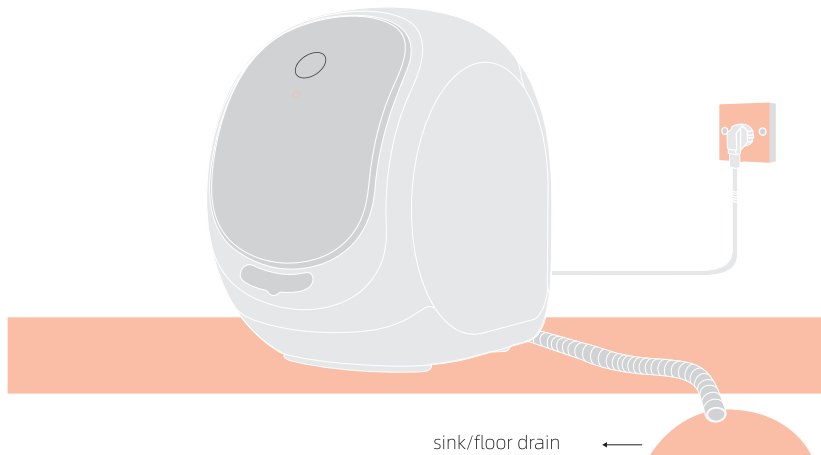

Removing transit bolts

2 Transit bolts must be removed before using the appliance.

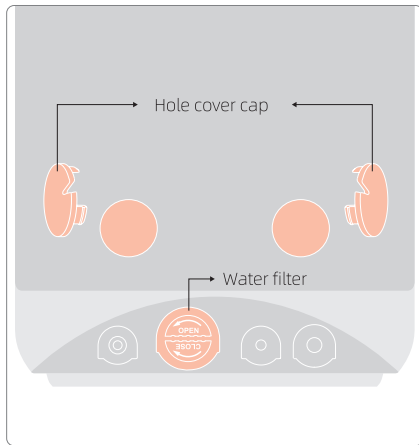
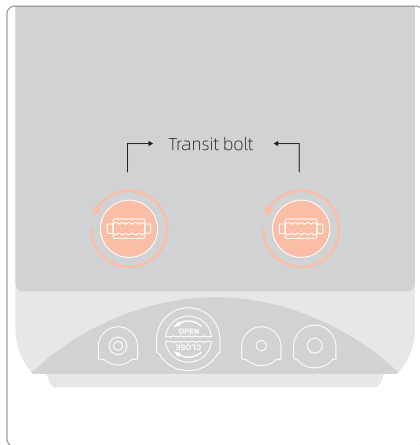

- 1 Rotate counterclockwise to remove the transit bolts. Keep the bolts for future use.
To prevent transport damage from occurring if the appliance is moved at a later date, you must refit the transit bolts before transporting the appliance.
- 2 Cover the holes with hole cover cap

Install water tank

Slide the water tank in to the slot.

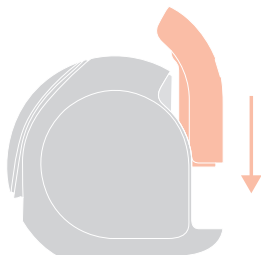

Install drain hose

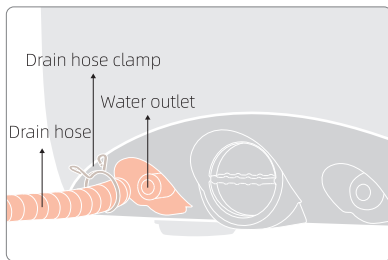

- 1 Connect the drain hose to the water outlet, and secure with the clamp.

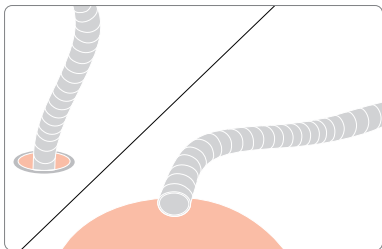

- 2 Insert the drain hose into the floor drain or drain pipe.

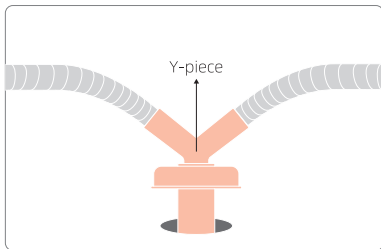

- 3 When installing 2 appliances, connect 2 drain hoses to the provided Y-piece.

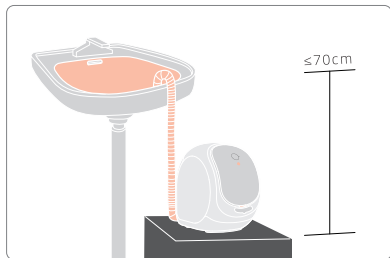

Note: The drain hose must be placed no more than 70cm (27.5inch) above from the water outlet.

How to use

Control panel

High Temp: Wash with high temperature water (approx. 95°C/203°F), kill bacteria with methods of pasteurization. Please make sure the fabrics withstand high temperature water.

Normal: Standard washing cycle with 30°C/86°F water, the all-purpose stain removal program for daily laundry.

Quick: Quick wash in 15 min for light stains or thinner clothes.

Wash & Dry: Normal wash and automatic drying.

Drum Clean: Drum self-clean with steam. Note: The drum must be emptied before starting the program.

Connect your appliance to the mobile App and unlock more washing programs.

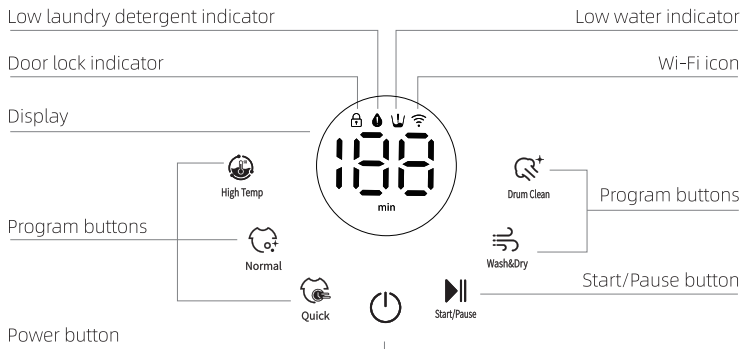

1. Door lock indicator

Indicator on: Door is locked.

Indicator off: Door is unlocked.

2. Low laundry detergent indicator

Indicator on: Laundry detergent is running out. Please change the cartridge.

Note: When indicator is on, there may be a small amount of detergent remaining for 1 washing cycle.

3. Low water indicator

Indicator on: Water level is low in the tank, please add water immediately.

Note: Error code E1 also appears on the display.

4. Wi-Fi indicator

Indicator on: Connected to Wi-Fi router.

Indicator flashes slowly: Waiting for connection.

Indicator flashes fast: Connection is lost, attempting reconnection.

5. Display

Display the remaining time of the washing/drying program, the reservation time, or the error code.

Note: The remaining time is an estimation based on standard environmental conditions and rated loading capacity. It might be different from the actual running time due to the temperature and humidity of the room or characteristics of the fabrics.

6. Program buttons

Press once to select the program.

7. Power button

Press and hold to turn on/off the appliance.

8. Start/Pause button

Press once to start/pause the program.

9. Open/Close the door

Open: Touch the bottom of the door.

Close: Push down from the top of the door (display area).

Push down on the door until you hear the latch click and notification sound.

Note: The door can only be opened when the power is connected. The door opens automatically after touching the bottom of the door. DO NOT open by force.



Automatic detergent dispenser

By using the daily neaty Bio Enzymes Laundry Detergent cartridge, it enables the precise automatic dosing for a better cleaning result.

Note: DO NOT add other detergents to the laundry when using the daily neaty Bio Enzymes Laundry Detergent.

Install the daily neaty Bio Enzymes Laundry Detergent cartridge

1. Flip open and raise the cartridge door.
2. Remove the stopper cap and foil seal on the cartridge and slide it into the slot until it snaps firmly into place. Close the cartridge door.

(The Automatic detergent dispenser optimizes the washing experience and result. If use alternative detergents, please choose low-foaming formula and less than 3ml for each load to prevent residue in the appliance or on the clothes that breeds bacteria and mold.)

(For the best cleaning result, please obtain the daily neaty Bio Enzymes Laundry Detergent cartridge from the official site or authorized sales channels.)

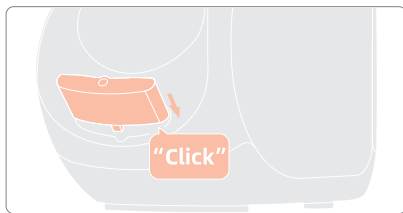
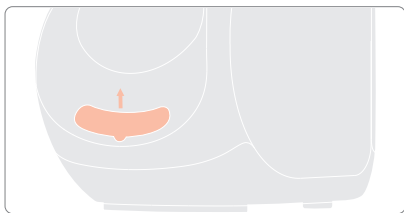

Other Functions

Door lock

The safety lock will be activated once a program starts, the 'lock icon' will show on the display. When the program ends, the 'lock icon' will disappear and the door will unlock.

Scheduling

The scheduling function can only be set on the mobile App. The finish time may vary depending on the actual condition of the room and fabric type of the laundry.

Scheduled drum cleaning function

Schedule a drum clean cycle on the mobile App. It is recommended running the drum clean every day before the laundry.

Power loss during cycle

If a power failure happens or the power plug is loose during a washing program, the progress of the cycle will be memorized, and the program will be resumed once the power supply is recovered.

Connecting to Mobile App

The mobile App activates all smart features of the appliance such as remote control, scheduling, software updates, etc.

Note: The following procedures might be changed in future updates. Please always follow the instructions on the App to connect.

Download

1. Scan the QR code below or search "Tuya Smart" in the App store. Download and install.



2. Turn on the Bluetooth function on the phone.
3. Make sure that the phone is connected to a 2.4GHz Wi-Fi network. If not sure, check the user manual of the network router or consult the service provider or the manufacturer.
4. Turn on the appliance.

Method One: Connecting via Bluetooth (Recommended)

Setting up the appliance for the first time, a pop-up should come on automatically when you launch the Tuya Smart App. Enter your home Wi-Fi name and password, it should connect automatically.

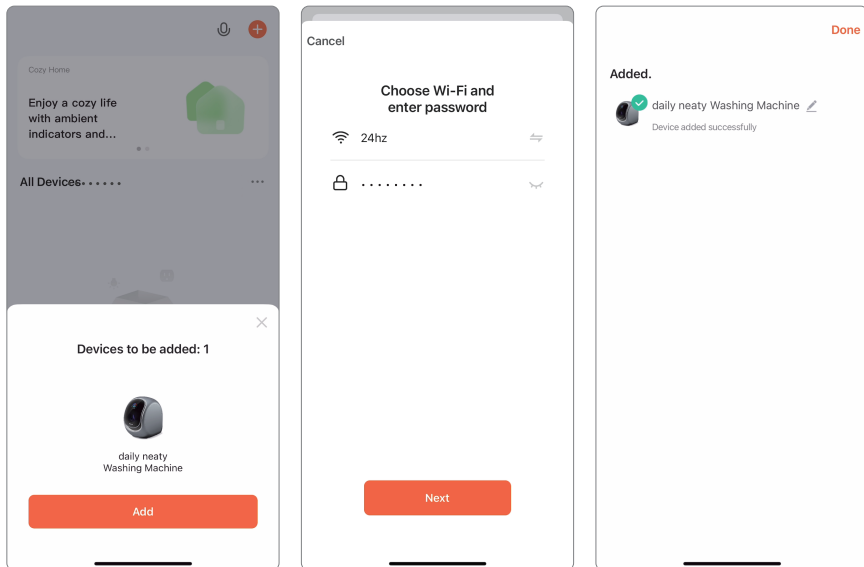

Method Two: Connecting by Search

In case of a Bluetooth discovery restriction is in place on the phone, click on the “+” button on the upper right corner and select “Add Device” to enter the search mode. The appliance should appear on the list of “Discovering devices...”. Click on the “Add” button to connect.

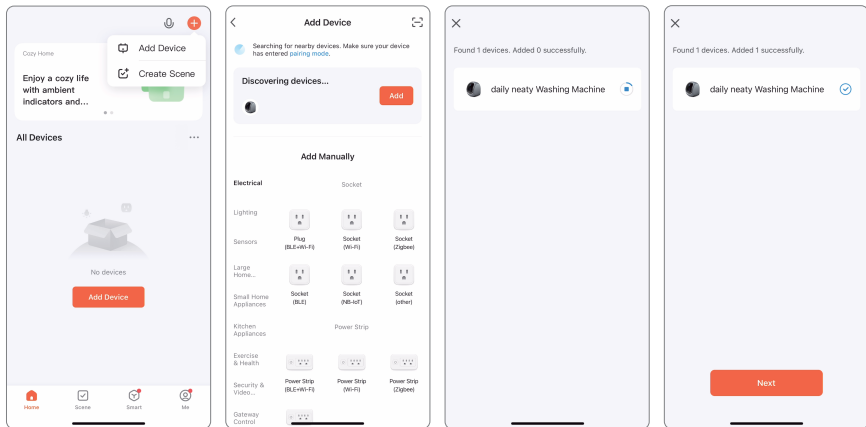

Method Three: Connecting via AP mode

If the phone is not capable of using Bluetooth, you can still use the Wi-Fi signal that comes from the appliance to establish the connection. Click on “Add Device” and then go to the category “Large Home Appliance”, select “Washing Machine (Wi-Fi)” and input the username and password of your home Wi-Fi.

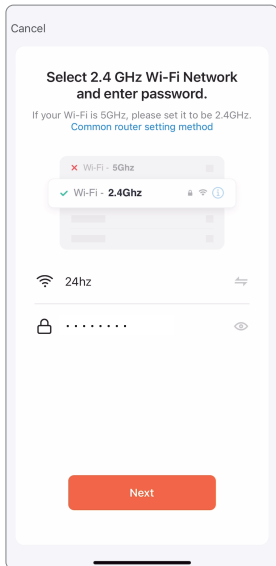
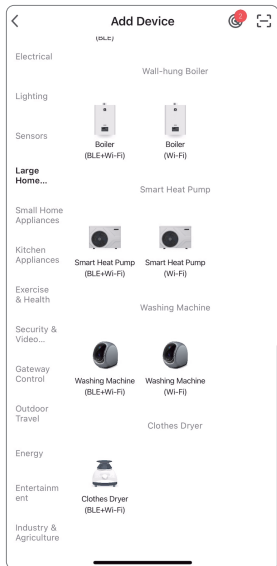
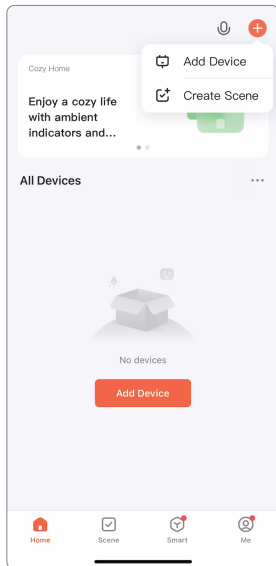

On the next page, click on “Next” and then select the option “Blink Slowly” . It will prompt you to go to the Wi-Fi setting on your phone. Connect now to the Wi-Fi signal from the appliance. The Wi-Fi name should be in the format of “SmartLife-XXXX” . Once connected, go back to the “Tuya Smart” App, the procedure should be resumed and complete in 1 minute.

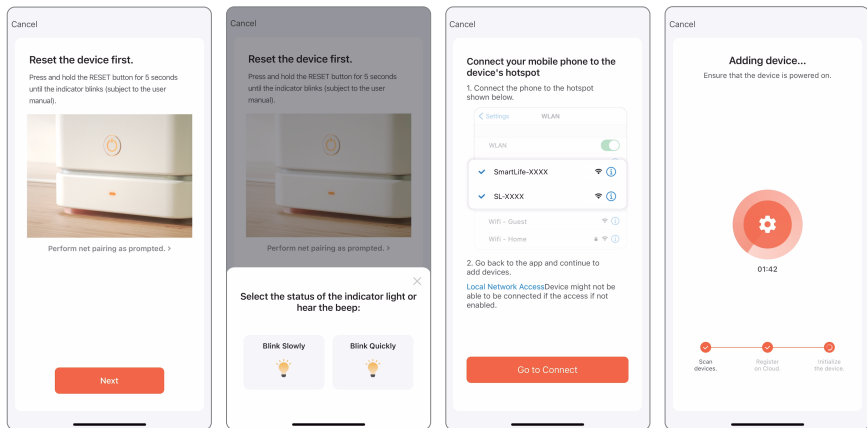

Preparing the wash load

1. Sort the laundry according to the symbols on the garment labels.
2. Separate white fabrics from colored fabrics. Wash new dark and colored garments separately at first.
3. Check all pockets to make sure that they are empty. Items such as nails, hair clips, matches, pens, coins and keys can damage both your appliance and clothes.
4. Wash delicates and clothes with hard decorating parts in a wash net.
5. Pre-treat dirt and stains by brushing a small amount of detergent onto stains to help lift dirt.
6. For the best cleaning result, use the daily neat laundry detergent with the automatic dispenser.

Checking drying symbols on the clothes care label

1. Clothes with below symbols are suitable for drying.



=Medium Heat



=Low Heat

DO NOT dry clothes with below symbols.



2. Do not dry silk, lace, leather, woolen articles, foam rubber (latex foam), shower caps and waterproof textiles.
3. Be careful when removing your clothing from the appliance, as the clothing or appliance may be hot.
4. Use the automatic drying program to dry most loads. Smart sensors measure the temperature and humidity of the exhaust to increase or decrease drying time and temperature and end the cycle automatically when it is done.

The estimated drying time varies from the actual drying time during the Automatic cycle. The type of fabric, size of the load, and the room condition affect drying time.

Troubleshooting

Determine the problem and find a solution.

State	Symptoms	Possible Cause and Solution
First use	Water residue or stain in the machine.	All units are water tested in the manufacturing process. Run 'Drum Clean' program to clean.
	Smell of rubber.	New rubber part and packing have natural smell, it is not harmful and will be reduced from time to time. Wipe clean or run 'Drum Clean' program.
During wash	Can not add laundry	Most program can be interrupted by press the 'Start/Pause' button. The program will be paused and door will unlock. When detecting a high water level or high temperature in the drum, safety lock will be activated and the door can not be open.
Spin	The laundry has not been spun properly and is still wet.	The machine detected an imbalance during the final spin cycle and reduced the spin speed automatically. Include both large and small items in the load as this will give better distribution during spinning.
	Rattling and clanking	1. Make sure all transit bolts are removed. 2. Floor is not rigid enough or level. Check if the floor is solid and does not flex or select a proper location.
	Does not drain water or drain slowly	1. Ensure that the drain hose is not kinked 2. Drain located higher than 70cm (27.5inch) above the water outlet 3. Check the water filter and make sure it is not clogged.
Other	Remaining time does not change on the display	If the imbalance is detected, the anti-tangling program will start and freeze the time until the imbalance is resolved.
	Program cycle time delayed	The appliance spends time to resolve the imbalance in the drum. Suds removing program initiates when detecting excessive amount of foam in the drum. The washing and drying time may vary by the amount of laundry, water pressure, water temperature and other usage conditions.

Error Codes

Code	Symptoms	Possible Cause and Solution
E1	Inlet Error	1. Check water level in the tank
E2	Drain Error	1. Drain hose is kinked or clogged. 2. The Drain filter is clogged.
E3	Door Error	Open the door and close it again.
EU	Spin Error	1. Make sure transit bolts are removed. 2. Check if any tangled, twisted, knotted clothes in the machine. 3. Make sure the floor does not flex.
H	Safety lock	Water overfills or high temperature in the drum. 1. Resume or run the program again to drain. 2. Wait until the drum cools down.
Other E or F code	Other Error	Power off using the power button, then unplug power cord from mains. Wait for 1 minute and power on again. If the error persists, contact customer service.

Cleaning and maintenance

Warning: To avoid risk of electric shock always disconnect the appliance from the power outlet prior to cleaning.

Cleaning the gasket

It is recommended wiping liquid starch regularly and check the folds in the gasket for any small articles, e.g. buttons, which might be lodged there.

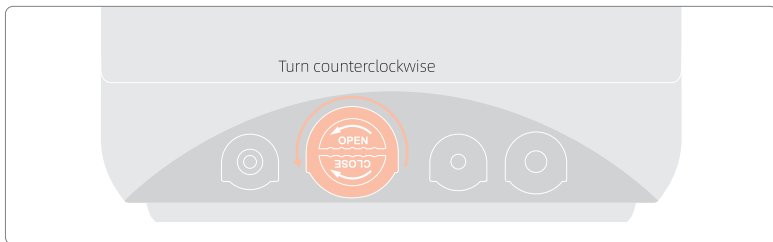

Cleaning the water filter

It is advisable to clean the water filter every month to prevent its clogging. Gently turn the filter cover counterclockwise to open, clean with a soft brush and make sure it is unclogged. Reinsert the filter and turn clockwise to lock.

Cleaning the drain hose and Y-piece

It is advisable to clean the drain hose and Y-piece every 6 months. Detach the hose and Y-piece and rinse with clean water. Reattach after cleaning.

Cleaning the drum

Run drum clean program regularly. Setting a cleaning schedule on the App can prevent the built-up of the odors and bacteria in the machine.

Specification

Product Name	All-in-One Washer-dryer
Version	Water Tank Version
Rated voltage	200-240V~
Frequency	50/60Hz
Rated Power (max.)	540W
Rated washing power	20W
Rated spinning power	70W
Rated heating power	480W
Rated drying power	180W
Water resistance rating	IPX4
Tank capacity	3.0L
Dimensions	265*405*430mm
Net/Gross	13 / 16kg
Rated capacity for washing and spinning	0.2kg
Rated capacity for drying	0.2kg
Maximum load volume	2.5L
Maximum spin speed	800rpm